

# Powering ON/OFF Sequence...

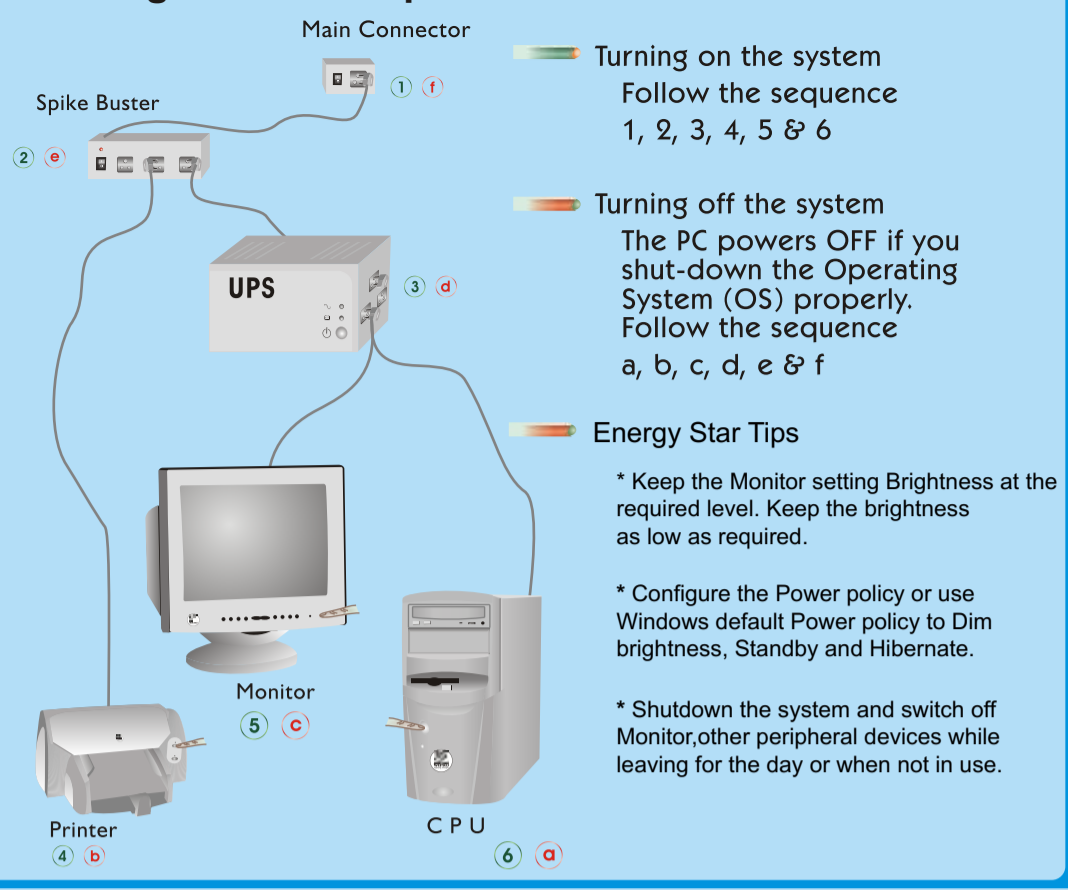

## QUICK START USER GUIDE

To protect the global environment and as an environmentalist, WIPRO reminds you that the products of "Electrical & Electronic Equipment" should not be discarded as municipal waste. Kindly contact your local Pollution control board for proper disposal. For further details, please visit <http://www.wipro.in>



### WIPRO LIMITED

Doddakannelli, Sarjapur Road, Bangalore - 560 035. INDIA.  
For Service Contact (Toll Free): 1800 200 3456; 1800 345 3456

[ecare@wipro.com](mailto:ecare@wipro.com)  
[www.wipro.in](http://www.wipro.in)

Note: Information provided in this document is subject to change without prior intimation. Please contact 1800 200 3456 / 1800 345 3456 (Toll Free Number) for updates on this product.

# Dear Valued Customer,

Thankyou for buying Wipro desktop product.

The information in this guide will help you to understand your desktop motherboard better by elaborating it's Specifications and Features along with basic settings.

Also included in this guide the desktop motherboard layout which gives you a better understanding of the where-abouts of important connectors and jumpers on the motherboard.

These information are for your understanding only. Please do not manipulate the desktop or any of it's components on your own as it will render it's warranty void.

Feel free to contact our service personnel at Toll Free Number **1800 200 3456 / 1800 345 3456** for any service related to your Wipro Desktop PC.

## SPECIFICATION

Processor	Supports Intel Core 2 Quad/Core 2 Duo/Pentium Dual core/Celeron Dual Core and Celeron ( Conroe-L)in the LGA 775 Package
FSB	1333/1066/800
Chipset	Northbridge:G41 & SouthBridge:ICH7
Memory	Two DIMM Slots Support for up to 4 GB of system memory Support for DDR3 1066 MHZ
Audio	ALC 662
LAN	Realtek 8111DL
System BIOS	AMI BIOS
BUS Architecture	PCI
EXPANSION SLOT	One x16 PCI-EX, one x1 PCI-EX, two x PCI slots
Rear IO Interface	1 PS/2 KBD / 1 PS/2 MOUSE/1 VGA Port / 1 PARALLEL PORT / 1 SERIAL Port / 1 LAN RJ45 / 4 USB Ports/ 5.1 channel Audio Ports with 3 audio jack
Internal IO Interface	4 X SATA 3Gbps/ 2 USB Header/1 Serial port Header/1x floppy connector / 1 x Speaker header/1 x IDE connector
OS Suport	Windows 7, Windows Vista SP1, Windows XP, SLED10 SP2.

## FEATURES

CPU	Supports Core™2 Quad/Core™2 Duo/ Pentium® Dual Core/ Celeron® Dual Core/ Celeron® 400 series processors in the LGA 775 Package
Memory	two DIMM Slots Support for up to 4GB of system memory Support for DDR3 1066 MHZ
Chipset	Northbridge:G41 & SouthBridge:ICH7 Supports One PCI-EX16 Slot Supports one PCI-EX1 slot Supports two PCI slots 4 Serial ATA Ports 4 Rear USB +2 x USB 2.0 headers support additional 4 USB Ports
BIOS	AMI BIOS with 8Mb SPI Flash ROM

### Do's

- It is advisable to protect the system from dust by using dust cover when the system is not in use.
- It is advisable to use power strips with surge protectors (spike busters) to protect your computer in case of power surge.
- Always use the system with proper electrical grounding.
- Run scan disk & disk defragmentation once in a month.
- Install antivirus software and scan all the floppies for virus before use. Periodic scanning of hard drives is a must.
- Update the antivirus for scanning new viruses. Free updates are available on the Internet.
- Write protect your floppies (this is a good way to keep viruses away).
- Keep all the documents (Invoice, License of Operating System, Warranty Card) & drivers (Motherboard Driver CD, etc.) Safe for future use.

### Don'ts

- Don't turn off the system directly by power ON/OFF switch.
- Don't move the system when it is ON.
- Don't connect or remove any peripheral when the system is in ON condition (e.g., Printer, Mouse, etc.)
- Don't spill any liquid on the system, monitor, keyboard, mouse or any other peripherals.
- Don't delete unknown files in your hard disk.
- Don't keep the floppies, CD, DVD media in places where dust, humidity, magnetic field or sunlight is present.
- Don't install pirated software as it may contain harmful viruses.
- Don't attempt to service the equipment yourself.

## REAR I/O CONNECTIONS

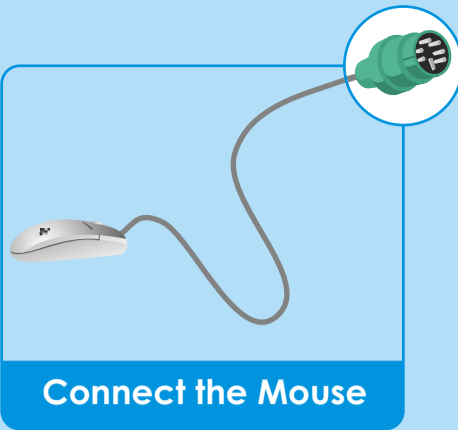

Connect the Mouse

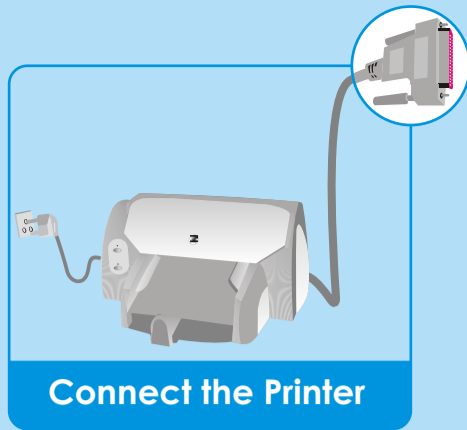

Connect the Printer

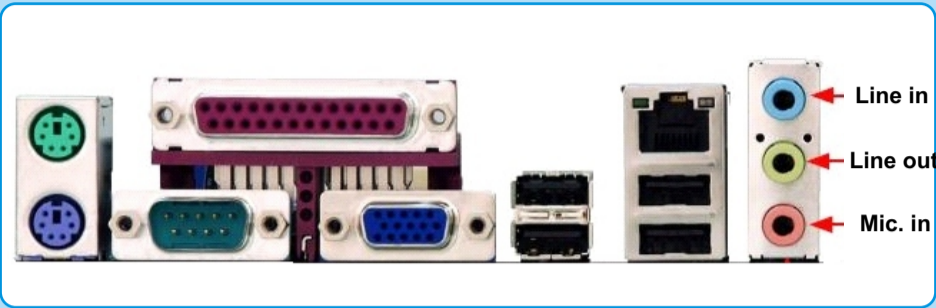

Line in  
Line out  
Mic. in

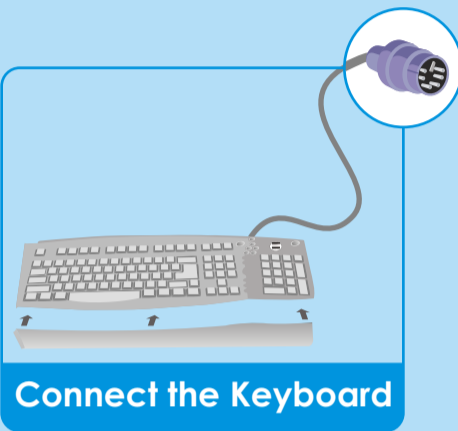

Connect the Keyboard



Connect USB Devices



Connect the Monitor

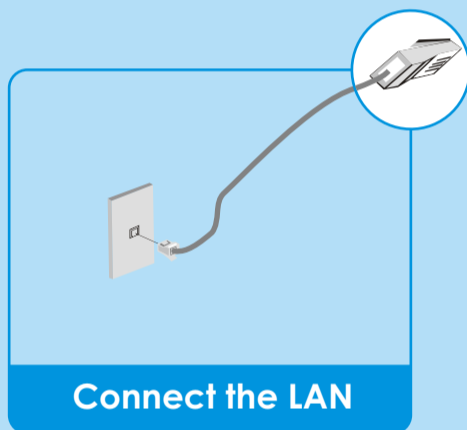

Connect the LAN



Connect the Audio

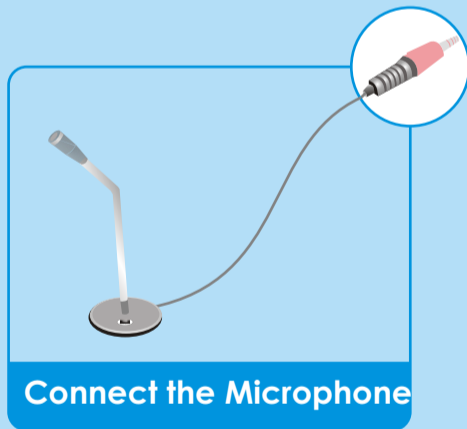

Connect the Microphone

## MOTHERBOARD LAYOUT

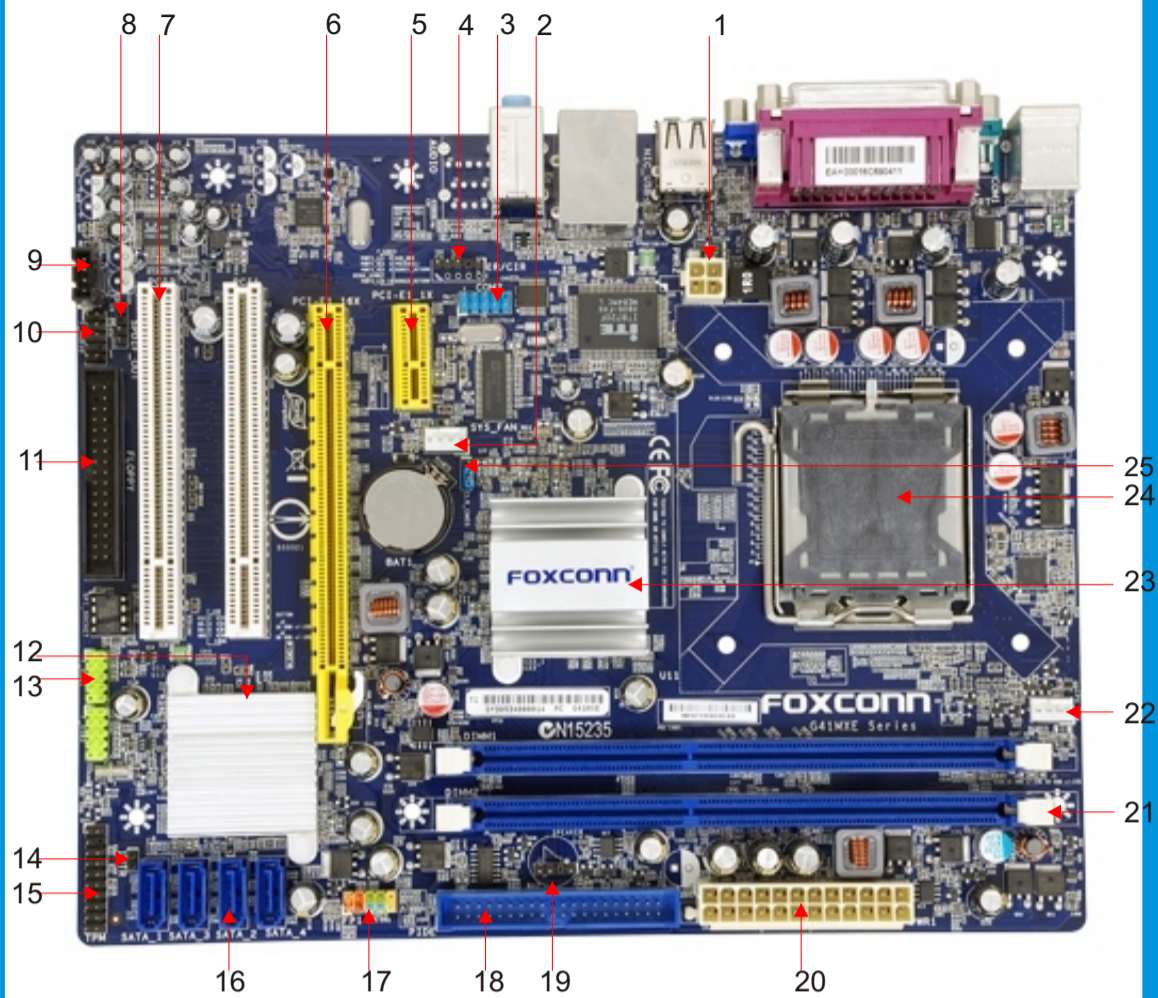

Label	Description	Label	Description
1	4-pin ATX 12V Power Connector	14	INTR Connector
2	SYS_FAN Header	15	TPM Connector
3	COM2 Connector	16	SATA Connectors
4	IR Connector	17	Front Panel Connector
5	PCI Express x1 Slot	18	IDE Connector
6	PCI Express x16 Slot	19	Speaker Connector
7	PCI Slots	20	24-pin ATX Power Connector
8	S/PDIF_OUT Connector	21	DDR3 DIMM Slots
9	CD_IN Connector	22	CPU_FAN Header
10	Front Audio Connector	23	North Bridge: Intel® G41
11	Floppy Connector	24	LGA 775 CPU Socket
12	South Bridge: Intel® ICH7	25	Clear CMOS Jumper
13	Front USB Connectors		

## CONNECTION DETAILS

### FRONT AUDIO (F\_AUDIO)

PIN	SIGNAL	DESCRIPTION
1	PORT 1L	Analog Port 1 - Left channel
2	GND	Ground
3	PORT 1R	Analog Port 1 - Right channel
4	PRESENCE#	Active low signal - signals BIOS that a High Definition Audio dongle is connected to the analog header. PRESENCE#=0 when a High Definition Audio dongle is connected.
5	PORT 2R	Analog Port 2 - Right channel
6	SENSE1_RETIRN	Jack detection return from frontpanelJACK1
7	SENSE_SEND	Jack detection sense line from the High Definition Audio CODEC jack detection resistor network
8	KEY	ConnectorKey
9	PORT 2L	Analog Port 2 - Left channel
10	SENSE2_RETIRN	Jack detection return from frontpanelJACK2

### FRONT USB (F\_USB2)

Pin	Signal Name	Function
1	USBPWR	Front Panel USB Power
2	USBPWR	Front Panel USB Power
3	USB_FP_P0-	USB Port 0 Negative Signal
4	USB_FP_P1-	USB Port 1 Negative Signal
5	USB_FP_P0+	USB Port 0 Positive Signal
6	USB_FP_P1+	USB Port 1 Positive Signal
7	GND	Ground
8	GND	Ground
9	Key	No pin
10	USB_FP_OC0	Overcurrent Signal

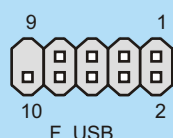
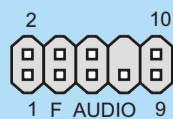

### FRONT PANEL

Pin	Signal Name	Function	Pin	Signal Name	Function
1	HD_LED_P	Hard disk LED(+)	2	FP PWR/SLP	MSG LED(+)
3	HD_LED_N	Hard disk LED(-)	4	FP PWR/SLP	MSG LED(-)
5	RST_SW_N	Reset Switch(-)	6	PWR_SW_P	Power Switch(+)
7	RST_SW_P	Reset Switch(+)	8	PWR_SW_N	Power Switch(-)
9	RSVD	Reserved	10	Key	No pin

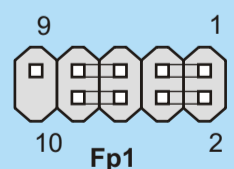

### CAUTION ESD



Electric-Static-Discharge (ESD) can damage electronic components. To prevent damage to your system board, it is important to handle it very carefully. The below precautions are generally sufficient to protect your equipment from ESD.

- Use a grounded wrist strap designed to prevent static discharge.
- Do not touch the gold contacts / pins on the motherboard / cards / devices.
- Put the motherboard and peripherals back into their antistatic bags when not in use.

### WARNING

Installation and service of this product to be performed only by qualified service personnel to avoid risk of injury from electrical shock or energy hazard.



### CAUTION

Observe normal ESD (Electrostatic Discharge) procedures during system integration or servicing to avoid possible damage to server board and/or other components.

